

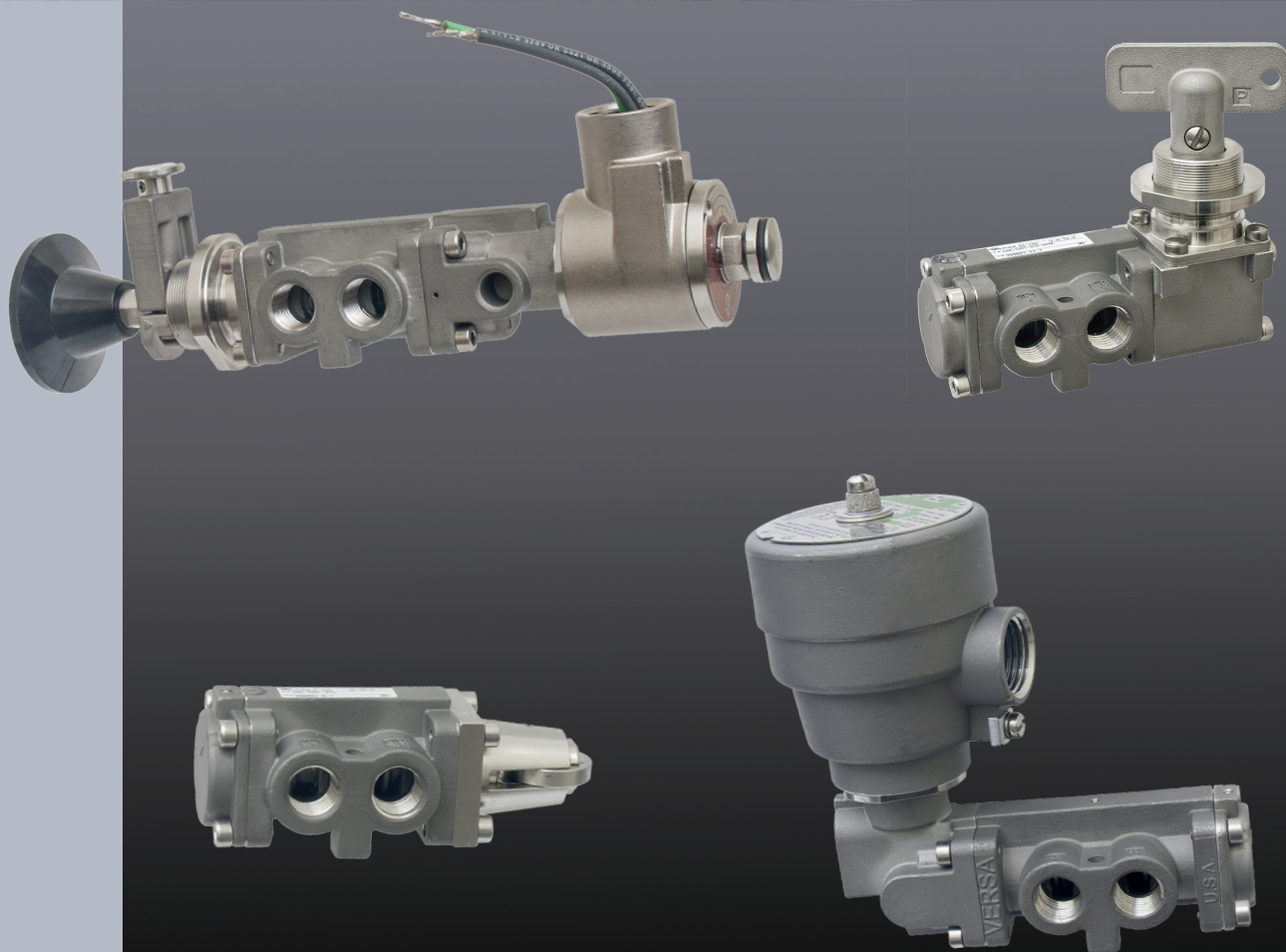

C-316 SERIES



THE C-316 SERIES

General Description.....	Page 3
Specifications.....	Page 4
Repair kits.....	Page 4
Cross Reference Chart.....	Page 5
Recommended Hazardous Location Solenoid Option Packages.....	Page 5

THE C-316 Side Ported

Solenoid Operated	
Solenoid Operated.....	Page 8
Solenoid, Palm button.....	Page 9
Solenoid Latching.....	Page 10
Electrical.....	Page 6-7-7
Pilot Operated	
Pilot Operated.....	Page 11
Pilot, Palm button,.....	Page 11 - 12
Pilot Latching.....	Page 12 - 13
Manually Operated	
Manual Palm Button.....	Page 13 - 14
Rotary.....	Page 14
Key.....	Page 15
Lock Out.....	Page 16
By Pass.....	Page 16
Mechanical	
CAM.....	Page 18



THE C-316 NAMUR

NAMUR – Direct Mount	
Solenoid Operated.....	Page 17
Latching.....	Page 17

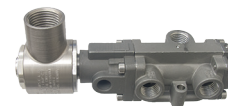

Options

Solenoid Manual Override.....	Page 18
Solenoid Vent Options.....	Page 18
Stainless Steel Tag.....	Page 18



THE C-316 SERIES

GENERAL DESCRIPTION

Series “C-316”

The C-316 Series consists of 3-Way 3/2 and 4-Way 5/2 investment cast, 316 stainless steel valves, in three categories: Side Ported, NAMUR style direct mount and CMAP, an integral stainless steel regulator and valve.

“C-316” Body Ported Valves

The C-316 Series is available as either a 4-way, for double acting devices or a 3-way, for spring return devices. The 3-way function can be specified as either normally closed or opened.

All solenoid actuators are solenoid/pilot type, which allows the use of the smallest solenoids available resulting in low power consumption. This design also assures a positive shifting force which makes certain the valve shifts when energized and reduces the chance of coil burnout. Single solenoid spring return models utilize an air assisted spring return feature assuring a positive return. Double solenoid models are equipped with a detent that maintains the valve in the last shifted position, even in high vibration environments.

A complete selection of electrical connections, power requirements and area classifications are available. See page 6-7

“C-316” Namur Valves

The Versa C-316 Series stainless steel NAMUR mount actuator control valve is a high flow, bubble-tight, 5-port, Pilot valve. It is designed to mount directly to any NAMUR actuator, thus reducing actuator response time and space.

Installed costs are also lower as the need for tubing, fittings, brackets and assembly labor are greatly reduced. All mounting screws and seals are included with valve.

The 5-port design allows the C-316 NAMUR to be ordered as either a 4-way, for double acting actuators or a 3-way, for spring return actuators. When the 3-way function is utilized, the unused exhaust port becomes an actuator vent where a filter/ muffler can be installed to prevent contaminants from entering either the valve or the actuator.

The 5-port design allows the user to independently control actuator speed in either the open or close direction. Speed or bleed controls are optional. See page 18.

CONSTRUCTION:

Balanced Spool

The forces required to actuate the plunger are unaffected by pressures being controlled assuring positive shifting throughout the entire range.

Wafer Sealing

Wafer type elastomer sealing provides leakproof operation throughout entire pressure range. The wafer/wiper style seal also provides a low friction profile.

Large Diameter Pilot

Large diameter pilot piston produces high shifting forces in Versa C-316 pilot and Solenoid actuated applications assuring a positive shifting force. The U cup offers friction free sealing for a positive shift.

Epoxy Molded Coil

Epoxy molding offers moisture resistance and heat dissipation in the toughest applications.

Air-Assisted Spring Return

Air boosts spring for positive valve return.

Investment Cast Stainless Steel

316 stainless steel components utilized for superior corrosion protection in the harshest environments. Investment cast components offer a first class finish while providing weight savings and superior flow.

Fully Ported – High Flow

Internal flow area equal to or greater than the area of the corresponding pipe/tube size.

High Performance Solenoid Actuator

All the C-316 Series solenoid valves utilize a high performance solenoid pilot design. This design utilizes available media pressure/force to shift valve assuring positive shifting. This design also produces the lowest wattage requirements in the industry.

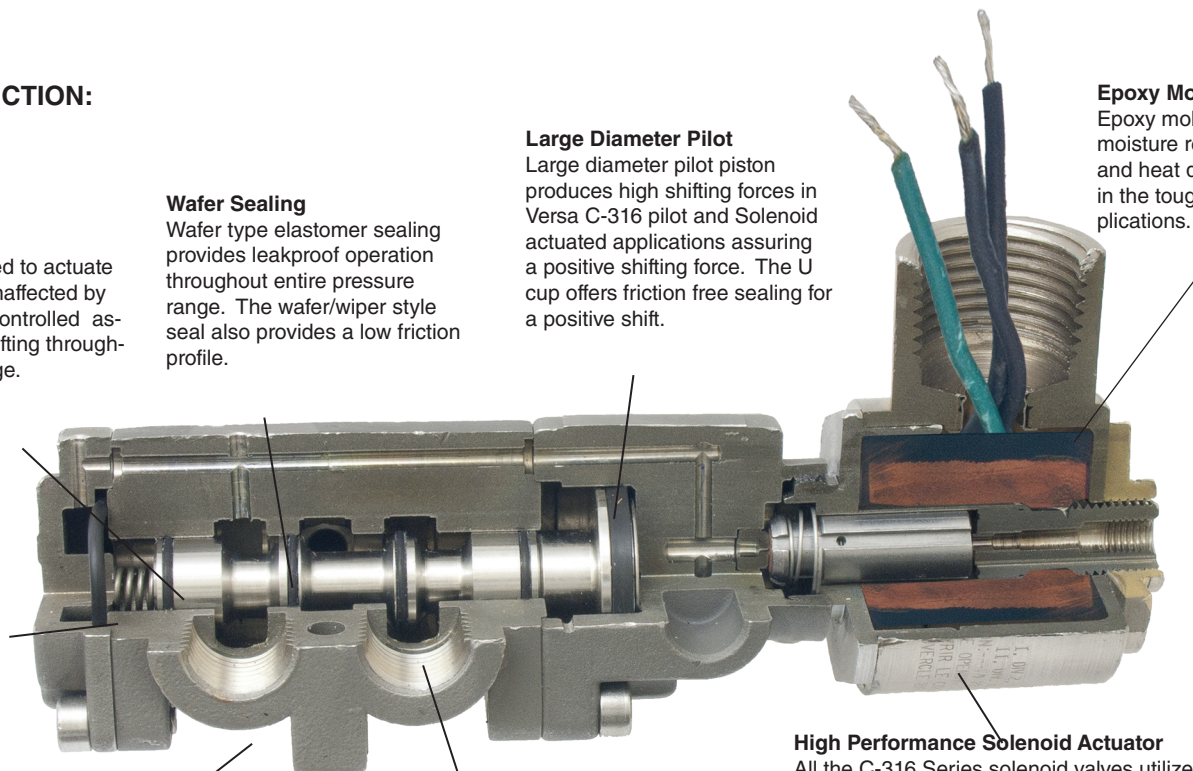

THE C-316 SERIES

Specifications

Flow Rate:	Cv = 2.0
NAMUR	Cv = 1.6
CMAP	Cv = 1.5
Port Size:	Inlet, cylinder and exhaust: 1/4" NPT
Media: C-316	Pneumatic*
CMAP	Pneumatic
Pilot:	Inpilot & Expilot solenoid valves
Temperature:	-5 to 200°F (-20 to 93° C), Media and ambient
Low Temp (-44 option) Manual:	-20 to 200°F (-29 to 93°C), Media and ambient
Pilot:	-55 to 200°F (-48 to 93°C), Media and ambient
Solenoid:	-40 (-40°C) to Max based on solenoid type

*For hydraulic service consult factory

Operating Pressure		
Valve Function	Minimum psi (bar)	Maximum psi (bar)
Single Solenoid Spring Return	25 (1.8)	150* (10.3)
Dual Solenoid Detent	15 (1.0)	150* (10.3)
Expilot Spring Return (with and without strong spring -S)	See Controlled (inlet) Pressure chart below	

*Exhaust restriction recommended for operating pressures over 125 psi (8.6 bar)

Pilot Operated Spring Return	Controlled (inlet) Pressure															
	psi		bar		psi		bar		psi		bar		psi		bar	
	25	1.7	30	1.2	50	3.4	70	4.8	90	6.2	110	7.6	130	9.0	150	10.3
Minimum Pilot Pressure Required	19	1.3	20	1.4	27	1.9	33	2.3	40	2.8	46	3.2	52	3.6	59	4.1

Materials:	
Valve body and internal parts:	316L stainless steel
Actuator caps:	316L stainless steel
Valve seals:	FKM (fluorocarbon)
Option	Low Temp Nitrile (" -44")
Screws:	Stainless steel
Solenoid internal parts:	304, 430F and 302 stainless steel
Solenoid Coil housing:	Depends on coil selected, see page 7

Repair kits		Repair Kit Number		
Prefix No.	Suffix No.	3-Way	4-Way	NAMUR
CAG, CGA CAP, CPA	136PE	C-3301-316-356AN	C-4302-316-356AN	*
CZA, CAZ	314E 357E	C-3301-316-AZ	C-4302-316-AZ	*
CSI, CIS CSA, CAS	Standard 357E	C-3301-316-S	C-4302-316-S	*
CSC, CCS CAI, CIA	Standard 150E			
CZI, CIZ CAI, CIA	Standard 173E	C-3301-316-ZI	C-4302-316-ZI	*
CAG, CGA CAG, CGA	356B 356BN	C-3321-316-356AN C-3321-316-356BN	C-4322-316-356AN C-4322-316-356BN	*
CAP, CPA CGG, CPP	Standard	C-3321-316-GG C-3321-316-SG	C-4322-316-GG C-4322-316-SP	C-4322-316-GG-NE *
CSP, CPS CSG, CGS	Standard	C-3321-316-SG	C-4322-316-SP	C-4322-316-SG-NE
CAP, CPA CSA, CAS	314E 314E	C-3301-316-AP C-3301-316-SI	C-4302-316-AP C-4302-316-SI	*
CIZ	LOV	C-3301-316-ZI-LOV	C-4302-316-ZI-LOV	*

*For NAMUR valve repair kits contact factory.

SELECTOR CHART & PRODUCT NUMBERING

Each letter and digit in the product number of a Versa Valve has a significant meaning, as explained below.

C Valve Series	S ACTUATING DEVICES Left Side* Right Side*	G Function (see Spool Details)	3 Port Size	3 Type of Body	2 Spool Details (flow pattern)	1 Material	316		XX		A120							
							Suffix Details		Mechanical		Electrical							
Series C-316 Valves	A Combination Actuators 136PE, -150E, -173E, -314E, -356B, -356BN, -357E see suffix column	2* Two-Way 2/2 3 Three-Way 3/2 4 Four-Way 5/2	3 1/4" NPT	0 Expilot Body with threaded side-ports (for Manual, Pilot and Expilot solenoid actuated valves)	Three-Way 3/2 Valves 1 Normally Closed 2 Normally Open	'316' indicates that the basic construction material for valve parts is AISI 316 Stainless Steel (Conforms to NACE Standard MR-01-75)	-CA3 CMAP identifier -NE_ NAMUR valve with 316 mounting screws, -NE1 10-28 -NE2 10-32 -NE3 M5	-DG Dust Proof -44 Low Temperature seals -U Up Right coil housing -ME Override, momentary contact Page 17	Electrical -HT High Temp coil -LA 0.85 Watt coil -LB 1.8 Watt coil -PC NEMA 4/4X -ST Stainless steel coil housing -U Upright solenoid end cap -XDB_ Stainless Steel housing, multi agency approvals									
	C Cam Operator	*Two-Way may be created by plugging the exhaust port of three-way valve bodies		2 Inpilot Body with threaded side-ports with internal drilling to supply inlet pressure to Solenoid-pilot actuator	Four-Way 5/2 Valves 2 2-Position		-ME Override, momentary contact Page 17	-XDB_ Stainless Steel housing, multi agency approvals										
	G Solenoid-pilot			3 Inpilot Manifold mounted with internal drilling to supply inlet pressure to Solenoid-pilot actuator. NAMUR Valve			Tagging -NV28A, Stainless steel ID tag; see Page 17											
	I Hand Button (for panel mounting)						Combination Actuators -136PE Palm Button, Spring Return Page 9 & 11											
	P Pressure-Pilot						-150E Pilot-2-Position Detent Page 12											
	S Spring Return (spring pushes valve spool)						-173E Solenoid, 2-Position Detent Page 9											
	Z 2-Position Detent (for 2-position manually operated valves)						-314E Key Operated Actuator Page 15											
	*NOTE "S" above is on left end of valve looking at inlet "G" above is on right end of valve looking at inlet						-356B Button Actuator W/ Latch – Reset Page 10 13 & 19											
							-356BN Actuator W/ Latch – Reset No Button Page 10, 12, 18 & 19											
							-357E Rotary Switch-2-Position Detent Page 14											
								Rating Code: A= 60Hz frequency D= Direct Current (DC) E= 50Hz frequency Three numbers follow the Rating Code to indicate voltage: Examples: <table border="1"> <tr> <th>Voltage</th> <th>Code</th> </tr> <tr> <td>24V60 =</td> <td>024</td> </tr> <tr> <td>120V60 =</td> <td>120</td> </tr> <tr> <td>24VDC =</td> <td>024</td> </tr> </table>	Voltage	Code	24V60 =	024	120V60 =	120	24VDC =	024		
Voltage	Code																	
24V60 =	024																	
120V60 =	120																	
24VDC =	024																	
								See page 5 for Suffix specifications										
								See page 7 for specific coil and codes.										

THE C-316 SERIES

Hazardous Location Combination Suffix Details Cross Reference Chart

Suffix Reference	
Suffix	Description
-CD	72" wire leads
-D14	Solenoid vent, water proof nut
-H2E	1/8" npt Solenoid vent
-HE	1/4" npt Solenoid vent
-HT	Class H coil
-L14	Solenoid vent dust nut
-LA	0.85 watt Solenoid
-LB	1.8 watt Solenoid
-LV	0.85 watt (World Solenoid)
-LX	1.8 watt (World Solenoid)
-LZ	0.5 watt (World Solenoid)
-PC	Potted coil; NEMA 4
-PS	Potted coil, male conduit;
-ST	Stainless Solenoid housing
-VJBT	Add on Junction Box
-XDBS	World Solenoid**
-XDBT	World Solenoid**
-XN	ATEX Solenoid
-XT	World Solenoid**
-XV	World Solenoid; North America
-XX	North American Solenoid
-303D	Integral diode

North American (-XX) (Cont.)	
Combination Suffix	Included Suffix
-XXK	-XX, -HT, -LB, -PC, -ST
-XXK4	-XX, -D14, -HT, -LB, -PC, -ST
-XXL	-XX, -PC
-XXL4	-XX, -D14, -PC
-XXM	-XX, -HT, -PC
-XXM4	-XX, -D14, -HT, -PC
-XXN	-XX, -LB, -PC
-XXN4	-XX, -D14, -LB, -PC
-XXQ	-XX, -HT, -LB
-XXQ4	-XX, -D14, -HT, -LB
-XXR	-XX, -LB
-XXR4	-XX, -D14, -LB
-XXS	-XX, -LA, -ST
-XXS4	-XX, -D14, -LA, -ST
-XXU	-XX, -HT, -LB, -ST
-XXU4	-XX, -D14, -HT, -LB, -ST
-XXV	-XX, -LA
-XXV4	-XX, -D14, -LA
-XXW	-XX, -CD, -HT, -H2, -PC, -ST
-XXW4	-XX, -D14, -CD, -HT, -PC, -ST

ATEX (-XN) (cont.)	
Combination Suffix	Included Suffix
-XNR	-XN, -LB
-XNS	-XN, -LA, -ST
-XNU	-XN, -HT, -LB, -ST
-XNV	-XN, -LA
-XNX	-XN, -LB, -PS
-XNWS	-XN, -VJBT, -LB, -PS

World Solenoid (-XDB, -XV, -XT)	
Combination Suffix	Included Suffix
-XDBS1	-XDBS, -HT, -LX
-XDBS2	-XDBS, -HT, -LX, -H2E
-XDBS3	-XDBS, -HT, -LX, -HE
-XDBS4	-XDBS, -HT, -LX, -L14
-XDBS5	-XDBS, -HT, -LX, -303D
-XDBS6	-XDBS, -HT, -LX, -H2E, -303D
-XDBS7	-XDBS, -HT, -LX, -HE, -303D
-XDBS8	-XDBS, -HT, -LX, -L14, -303D
-XDBS9	-XDBS, -HT, -LX, -D14
-XDBS10	-XDBS, -HT, -LX, -D14, -303D
-XDBT1	-XDBT, -HT, -LX
-XDBT2	-XDBT, -HT, -LX, -H2E
-XDBT3	-XDBT, -HT, -LX, -HE
-XDBT4	-XDBT, -HT, -LX, -L14
-XDBT5	-XDBT, -HT, -LX, -303D
-XDBT6	-XDBT, -HT, -LX, -H2E, -303D
-XDBT7	-XDBT, -HT, -LX, -HE, -303D
-XDBT8	-XDBT, -HT, -LX, -L14, -303D
-XDBT9	-XDBT, -HT, -LX, -D14
-XDBT10	-XDBT, -HT, -LX, -D14, -303D
-XV1	-XV, -HT, -LX
-XV2	-XV, -HT, -LX, -H2E
-XV3	-XV, -HT, -LX, -HE
-XV4	-XV, -HT, -LX, -L14
-XV9	-XV, -HT, -LX, -D14
-XT1	-XT, -HT, -LX
-XT2	-XT, -HT, -LX, -H2E
-XT3	-XT, -HT, -LX, -HE
-XT4	-XT, -HT, -LX, -L14
-XT9	-XT, -HT, -LX, -D14

North American (-XX)	
Combination Suffix	Included Suffix
-XXA	-XX, -HT
-XXA4	-XX, -D14, -HT
-XXB	-XX, -PS
-XXB4	-XX, -D14, -PS
-XXC	-XX, -HT, -PS
-XXC4	-XX, -D14, -HT, -PS
-XXD	-XX, -ST
-XXD4	-XX, -D14, -ST
-XXE	-XX, -PC, -ST
-XXE4	-XX, -D14, -PC, -ST
-XXF	-XX, -HT, -ST
-XXF4	-XX, -D14, -HT, -ST
-XXG	-XX, -LB, -ST
-XXG4	-XX, -D14, -LB, -ST
-XXH	-XX, -HT, -PC, -ST
-XXH4	-XX, -D14, -HT, -PC, -ST
-XXJ	-XX, -LB, -PC, -ST
-XXJ4	-XX, -D14, -LB, -PC, -ST

ATEX (-XN)	
Combination Suffix	Included Suffix
-XNA	-XN, -HT
-XND	-XN, -ST
-XNE	-XN, -PC, -ST
-XNE4	-XN, -D14, -PC, -ST
-XNF	-XN, -HT, -ST
-XNG	-XN, -LB, -ST
-XNH	-XN, -HT, -PC, -ST
-XNJ	-XN, -LB, -PC, -ST
-XNJ4	-XN, -D14, -LB, -PC, -ST
-XNK	-XN, -HT, -LB, -PC, -ST
-XNL	-XN, -PC
-XNL4	-XN, -D14, -PC
-XNM	-XN, -HT, -PC
-XNN	-XN, -LB, -PC
-XNN4	-XN, -D14, -LB, -PC
-XNP	-XN, -HT, -LB, -PC
-XNQ	-XN, -HT, -LB

Recommended Hazardous Location Solenoid Option Packages



	Certification/Power			
	North American - CSA		ATEX - IECEx - INMETRO	
Enclosure/Wire	Standard Power	Low Watt*	Standard Power	Low Watt*
Steel, Electroless Nickel Plated, 24 Inch Leads	-XXL4	-XXN4	-XNL4	-XNN4
Stainless Steel, High Performance 430 type, 24" wire leads	-XXE4	-XV9	-XNE4	-XT9**
Stainless Steel, 316L type, Junction Box with Terminal Strip	—	-XDBT9**	—	-XDBS9**

*1.8 watt solenoid. Also available 0.5 and 0.85 watt. Consult factory for availability.

**All the -XDBS, -XDBT & -XT solenoids are "World Solenoids" certified for North America, ATEX, IECEx and INMETRO and more. -XV solenoids certified for North America.

For complete solenoid specifications please see above and page 6-7.

NON HAZARDOUS LOCATIONS OPERATORS

	Suffix Identification	Protection Classification	Area Classification and (Gas Grouping)	Certification-(Conformance)	Ingress Protection
	None or -HT, PC	General Purpose	Indoor & Outdoor	CSA	NEMA 1,2, 3 & 4
	-HC -HCC (Shown)	General Purpose	Indoor & Outdoor	CSA	NEMA 4; IP65

HAZARDOUS LOCATION SOLENOIDS

	Agency Approvals		North America 		World*   	Ingress Protection	
	Suffix*	Protection Classification	Zones	Divisions	Area Classification and (Gas Grouping)		Agency
	-XX	Hazardous Locations	—	CL I, DIV 1, Grp (C & D) CL II, DIV 1, Grp (E, F & G) Temp T3C CL I, DIV 2 Grp (A B C) CL II, DIV 2 Grp (E, F & G) Temp T3C	—	UL CSA	NEMA 7 & 9
	-XN	(d) Flameproof	—	—	Ex d IIB+H2 T3...T6 Gb II 2 G Ex d IIB+H2 T3...T6 Gb	IECEX ATEX	IP66/67
	-XV	Hazardous Locations	—	—	—	CSA _{US}	NEMA 4, 4X, 6P, IP66
	-XT	(d) Flameproof	—	CL I, DIV 1, Grp (B, C, D) CL II, DIV 1, Grp (E, F, G) CL III CL I, DIV 2, Grp (A, B, C, D) CL II, DIV 1, Grp (E, F, G) CL III	—	—	—
	-XDBT	(d) Flameproof (e) Increased Safety	CL, I, Zn 1 A/Ex de IIC T* CL, II Zn, 21 AEx tD A21, DIP A21	—	Ex II 2 G D A/Ex d e IIC T3...T6 Gb Ex tb IIIC T3...T6 Db	ATEX - IECEX INMETRO	IP66/67/68
	-XDBS						
	-XMAA -XMAF	(mb) Encapsulation	—	—	Ex e mb IIC T5, T6 Gb Ex tb IIIC T85°C, T100°C Db II 2 G Ex e mb IIC T5...T6 Gb II 2 D Ex tb IIIC T85°C...T100°C Db	IECEX TR CU ATEX	IP67
	-XMFA -XMFF	(e) Increased Safety (tD) Tight Dust					
	-XIFA	(ia) Intrinsic Safe	—	—	Ex (ia) IIC T4...T6 Gb Ex (ia) IIIC T130°C...T80°C Db II 2 G Ex ia IIC T4...T6 II 2 D Ex iaD 21 T130°C, T80°C	IECEX TR CU ATEX	IP67
	-XIFF						
	-HC-XISX6- (Shown)	Intrinsic Safe	—	CL I, DIV 1, Grp (A,B,C & D) CL II, DIV 1, Grp (E, F, & G) CL III	II 2 G Ex ia IIC T4...T6 Gb II 2 G Ex ia IIB T4...T6 Gb	ATEX IECEX TR CU CSA FM	IP65
	-HCC-XISX6						

*Recommended solenoid options. See page 5

COIL CODES: Identify the solenoid frequency and voltage consisting of a "Rating Code" and "Voltage" as shown at right. Coil codes complete the part number for a solenoid operated valve.

Rating Code
 A = 60Hz frequency
 D = Direct Current (DC)
 E = 50Hz frequency

Voltage
 Indicated by three digits:
 e.g. 24 volts = 024
 120 volts = 120

A120 = AC, 120Volts/60hz

	Voltage (Power)	Electrical Characteristics	Miscellaneous
	All usual 50 Hz & 60 Hz AC (7.3W) All usual DC (9.5W)	Class F epoxy molded coil (155°C). Continuous duty, 2 leads 24" (60 cm).	Steel cover with 1/2 NPT conduit entry.
	24V60, 120V60, 240V60 (8.5W) 24V50, 110V50, 220V50 (8.5W) 12VDC, 24VDC, 48VDC (10.5W)	Class F epoxy molded coil (155°C), with 3 spade terminals and mini DIN socket with PG9 cable gland. Continuous duty.	Mini DIN socket with PG9 cable gland (-HC) or 1/2" conduit connection (-HCC).

	Voltage (Power)	Electrical Characteristics	Miscellaneous																																																														
	50 Hz & 60 Hz AC (6W), DC (7.2W) & (1.8W) AC: 12V60 (A012), 24V60 (A024), 48V60 (A048), 120V60 (A120), 240V60 (A120) DC: 6VDC (D006), 12VDC (D012), 24VDC (D024), 48VDC (D048)	Class F epoxy molded coil (155°C). continuous duty. 3 leads 24" (60 cm).	Plated steel coil housing with 1/2 NPT conduit entry. For additional (-XX) solenoid options see page 5. Plated steel coil housing with M20 x 1.5 conduit entry. Ground terminal on cover. For additional (-XN) solenoid options see page 5.																																																														
	AC: 120V60HZ (A120), 240V60HZ (A240) 110V50HZ (E110), 220V50HZ (E230) DC: 12VDC (D012), 24VDC (D024) 48VDC (D048), 120VDC (D120) 1.8 watt standard. For 0.85 watt consult factory.	Epoxy molded coils rated for continuous duty, Class H – 180°C.	<table border="1"> <thead> <tr> <th rowspan="2">Stainless steel coil housing</th> <th colspan="2">Suffix Detail Option Packabe</th> </tr> <tr> <th>XV</th> <th>XT</th> </tr> </thead> <tbody> <tr> <td></td> <td colspan="2">1.8 watt</td> </tr> <tr> <td>Standard (vent to atmosphere)</td> <td>-XV1</td> <td>-XT1</td> </tr> <tr> <td>1/8" Adapter (-H2E)</td> <td>-XV2</td> <td>-XT2</td> </tr> <tr> <td>1/4" Adapter (-HE)</td> <td>-XV3</td> <td>-XT3</td> </tr> <tr> <td>Dust Nut (-L14)</td> <td>-XV4</td> <td>-XT4</td> </tr> <tr> <td>Water proof nut (-D14)</td> <td>-XV9*</td> <td>-XT9*</td> </tr> </tbody> </table> <table border="1"> <thead> <tr> <th rowspan="2">Stainless steel coil housing with internal Junction Box. Internal and external ground screw.</th> <th colspan="4">Suffix Detail Ordering Code</th> </tr> <tr> <th colspan="2">M 20 Connection</th> <th colspan="2">1/2" Connection</th> </tr> <tr> <td></td> <th>No Diode</th> <th>Diode</th> <th>No Diode</th> <th>Diode</th> </tr> </thead> <tbody> <tr> <td>Standard (vent to atmosphere)</td> <td>XDBS1</td> <td>XDBS5</td> <td>XDBT1</td> <td>XDBT5</td> </tr> <tr> <td>1/8" Adapter (-H2E)</td> <td>XDBS2</td> <td>XDBS6</td> <td>XDBT2</td> <td>XDBT6</td> </tr> <tr> <td>1/4" Adapter (-HE)</td> <td>XDBS3</td> <td>XDBS7</td> <td>XDBT3</td> <td>XDBT7</td> </tr> <tr> <td>Dust Nut (-L14)</td> <td>XDBS4</td> <td>XDBS8</td> <td>XDBT4</td> <td>XDBT8</td> </tr> <tr> <td>Dust Excluder (-D14)</td> <td>XDBS9*</td> <td>XDBS10</td> <td>XDBT9*</td> <td>XDBT10</td> </tr> </tbody> </table>	Stainless steel coil housing	Suffix Detail Option Packabe		XV	XT		1.8 watt		Standard (vent to atmosphere)	-XV1	-XT1	1/8" Adapter (-H2E)	-XV2	-XT2	1/4" Adapter (-HE)	-XV3	-XT3	Dust Nut (-L14)	-XV4	-XT4	Water proof nut (-D14)	-XV9*	-XT9*	Stainless steel coil housing with internal Junction Box. Internal and external ground screw.	Suffix Detail Ordering Code				M 20 Connection		1/2" Connection			No Diode	Diode	No Diode	Diode	Standard (vent to atmosphere)	XDBS1	XDBS5	XDBT1	XDBT5	1/8" Adapter (-H2E)	XDBS2	XDBS6	XDBT2	XDBT6	1/4" Adapter (-HE)	XDBS3	XDBS7	XDBT3	XDBT7	Dust Nut (-L14)	XDBS4	XDBS8	XDBT4	XDBT8	Dust Excluder (-D14)	XDBS9*	XDBS10	XDBT9*	XDBT10
Stainless steel coil housing	Suffix Detail Option Packabe																																																																
	XV	XT																																																															
	1.8 watt																																																																
Standard (vent to atmosphere)	-XV1	-XT1																																																															
1/8" Adapter (-H2E)	-XV2	-XT2																																																															
1/4" Adapter (-HE)	-XV3	-XT3																																																															
Dust Nut (-L14)	-XV4	-XT4																																																															
Water proof nut (-D14)	-XV9*	-XT9*																																																															
Stainless steel coil housing with internal Junction Box. Internal and external ground screw.	Suffix Detail Ordering Code																																																																
	M 20 Connection		1/2" Connection																																																														
	No Diode	Diode	No Diode	Diode																																																													
Standard (vent to atmosphere)	XDBS1	XDBS5	XDBT1	XDBT5																																																													
1/8" Adapter (-H2E)	XDBS2	XDBS6	XDBT2	XDBT6																																																													
1/4" Adapter (-HE)	XDBS3	XDBS7	XDBT3	XDBT7																																																													
Dust Nut (-L14)	XDBS4	XDBS8	XDBT4	XDBT8																																																													
Dust Excluder (-D14)	XDBS9*	XDBS10	XDBT9*	XDBT10																																																													
24VDC (4W) (Consult factory for other voltage options)	Continuous duty coil & rectifier, including surge suppression, potted within housing.	Thick wall epoxy coil housing with integral junction box. Internal ground terminal.	M20 x 1.5 conduit entry: (-XMAA), (-XMFA), 1/2 NPT conduit entry with adapter: (-XMAF), (-XMFF).																																																														
24VDC 10W inrush, 2.6W holding) (Consult factory for other voltages)	Continuous duty coil & power controller potted within housing.	Requires the use of an approved safety barrier or isolator. Thick wall epoxy coil housing and integral junction box. Internal ground terminal.																																																															
24VDC (0.8W) (Consult factory for other voltages)	Continuous duty coil and power controller potted within housing.	M20 x 1.5 conduit entry: (-XIFA). 1/2 NPT conduit entry with adapter: (-XIFF).																																																															
24VDC (1.6 watt max.) System voltage prior to barrier	Class F epoxy molded coil (155°C). Continuous duty.	Requires the use of an approved barrier or isolator. Maximum operating system voltage before barrier 28VDC. Maximum pilot pressure 115 psi (8 bar). 3 spade terminals, ISO DIN 43650 Form "A" PG9 cable gland (-HC). 1/2 NPT conduit entry: (-HCC). Low temperature Buna seals standard.																																																															

*Recommended solenoid options. See page 5

THE C-316 SERIES

Mounting Hole Dimensions Side Ported Valves

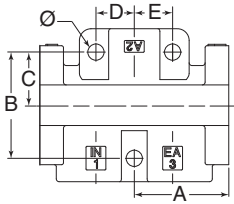

Mounting Hole Dimensions	A	A	B	C	D	E	Ø
	3-Way	4-Way					
Inches	1.0	1.25	1.13	0.56	0.41	0.41	0.17
mm	25.4	31.8	28.6	14.3	10.3	10.3	4.4

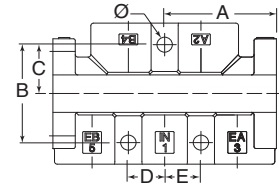

Optional Upright Coil Housing

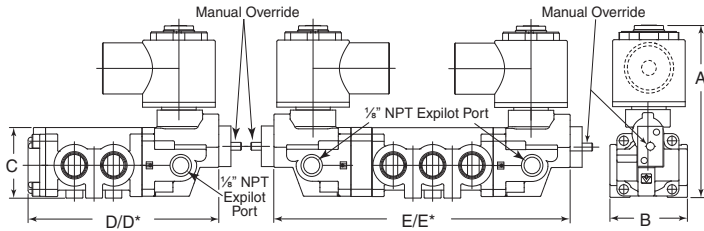

Available as an option on side ported valves.

Recommended for use with -XDB_, -XMA_, -XMF_ & XIF_ coils on NAMUR valves for mounting clearance.

Solenoid shown is hazardous location type -XX. For more options see page 6-7.

	A	B	C	D	D*	E	E*
Side Ported							
Inches	2.8	1.62	1.42	5.41	5.91	8.53	9.0
mm	72.1	41.1	36.1	137.5	150.1	217	288.6
NAMUR							
Inches	2.8	1.63	1.44	4.14	4.14	7.25	7.25
mm	72.1	41.3	36.6	105.2	105.2	184.2	184.2

Body Ported Valves

SOLENOID OPERATED

Side Ported	Function	Actuation	Pilot Type	Part Number	Weight	Flow Symbol
	3-Way 2-Position Normally Closed 3/2	Single Solenoid Spring Return	Inpilot	CSG-3321-316-(*)	1.6 lbs 0.7 kg	
			Expiport	CSG-3301-316-(*)		
	3-Way 2-Position- Normally Open 3/2	Single Solenoid Spring Return	Inpilot	CGS-3322-316-(*)	1.6 lbs 0.7 kg	
			Expiport	CGS-3302-316-(*)		
	3-Way 2-Position 3/2	Double Solenoid Detent	Inpilot	CGG-3321-316-(*)	2.5 lbs 1.1 kg	
			Expiport	CGG-3301-316-(*)		
	4-Way 2-Position 5/2	Single Solenoid Spring Return	Inpilot	CSG-4322-316-(*)	1.7 lbs 0.8 kg	
			Expiport	CSG-4302-316-(*)		
	4-Way 2-Position 5/2	Double Solenoid Detent	Inpilot	CGG-4322-316-(*)	2.6 lbs 1.2 kg	
			Expiport	CGG-4302-316-(*)		

* Add solenoid/coil voltages (page 7) & Suffix from Selector Chart (page 4)

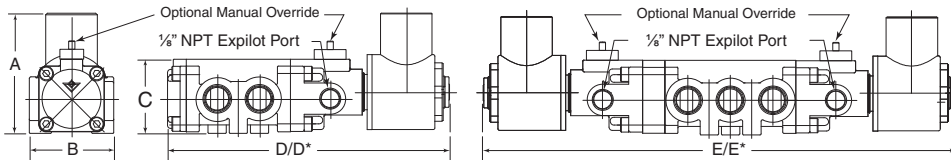

Solenoid shown is hazardous location type -XX. For more options see page 6-7.

	A	B	C	D	D*	E	E*
Inches	2.8	1.62	1.42	5.41	5.91	8.53	9.0
mm	72.1	41.1	10.3	137.5	150.1	217	288.6

THE C-316 SERIES

Body Ported Valves

SOLENOID, PALM BUTTON with SPRING RETURN

Side Ported	Function	Actuation	Pilot Type	Part Number	Weight	Flow Symbol
	3-Way 2-Position Normally Closed 3/2	Single Solenoid Palm Button Spring Return	Inpilot	CAG-3321-316-136PE-(*)	2.0 lbs 0.9 kg	
			Expilot	CAG-3301-316-136PE-(*)		
	3-Way 2-Position Normally Open 3/2	Single Solenoid Palm Button Spring Return	Inpilot	CGA-3322-316-136PE-(*)	2.0 lbs 0.9 kg	
			Expilot	CGA-3302-316-136PE-(*)		
	4-Way 2-Position 5/2	Single Solenoid Palm Button Spring Return	Inpilot	CAG-4322-316-136PE-(*)	2.1 lbs 1.0 kg	
			Expilot	CAG-4302-316-136PE-(*)		

* Add solenoid/coil voltages (page 7) & Suffix from Selector Chart (page 4)

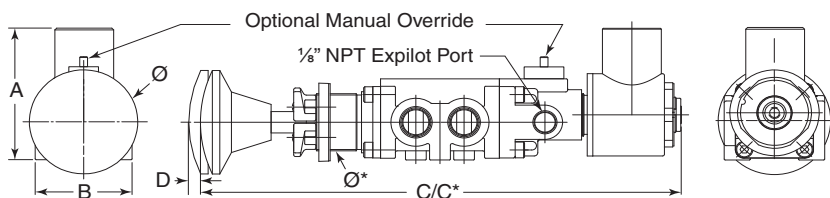

	A	B	C	C*	D	Ø	Ø*
Inches	2.3	1.62	8.08	8.58	.20	1.81	1.0
mm	58.4	41.2	205.2	217.9	5.08	46	25.4

For mounting hole dimensions see page 8

Solenoid shown is hazardous location type -XX. For more options see page 6-7.
Manual override see page 17

SINGLE SOLENOID, PALM BUTTON with DETENT

Side Ported	Function	Actuation	Pilot Type	Part Number	Weight	Flow Symbol
	3-Way 2-Position Normally Closed 3/2	Single Solenoid Detent with Button	Inpilot	CIA-3321-316-173E-(*)	2.1 lbs 1.0 kg	
			Expilot	CIA-3301-316-173E-(*)		
	3-Way 2-Position- Normally Open 3/2	Single Solenoid Detent with Button	Inpilot	CAI-3322-316-173E-(*)	2.1 lbs 1.0 kg	
			Expilot	CAI-3302-316-173E-(*)		
	4-Way 2-Position 5/2	Single Solenoid Detent with Button	Inpilot	CAI-4322-316-173E-(*)	2.2 lbs 1.0 kg	
			Expilot	CAI-4302-316-173E-(*)		

* Add solenoid/coil voltages (page 7) & Suffix from Selector Chart (page 4)

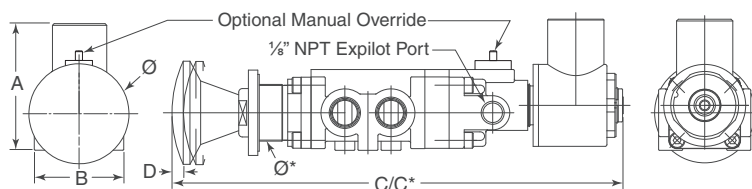

	A	B	C	C*	D	Ø	Ø*
Inches	2.3	1.62	7.92	8.42	.20	1.81	1.0
mm	58.4	41.2	201.2	213.8	5.08	46	25.4

For mounting hole dimensions see page 8

Solenoid shown is hazardous location type -XX. For more options see page 6-7.
Manual override see page 17

THE C-316 SERIES

Body Ported Valves

LATCHING, SINGLE SOLENOID, SPRING RETURN without PALM BUTTON

Side Ported	Function	Actuation	Pilot Type	Part Number	Weight	Flow Symbol
	3-Way 2-Position Normally Closed 3/2	Single Solenoid Spring Return	Inpilot	CAG-3321-316-356BN-(*)	1.9 lbs 0.9 kg	
			Expilot	CAG-3301-316-356BN-(*)		
	3-Way 2-Position- Normally Open 3/2	Single Solenoid, Latching Reset	Inpilot	CGA-3322-316-356BN-(*)	1.9 lbs 0.9 kg	
			Expilot	CGA-3302-316-356BN-(*)		
	4-Way 2-Position 5/2	Single Solenoid Latching Reset	Inpilot	CAG-4322-316-356BN-(*)	2.0 lbs 0.9 kg	
			Expilot	CAG-4302-316-356BN-(*)		

* Add solenoid/coil voltages (page 7) & Suffix Details from Selector Chart (page 4)

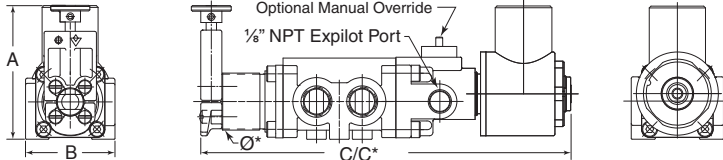

	A	B	C 3-Way	C* 4-Way	Ø*
Inches	2.3	1.62	6.5	7.0	1.0
mm	58.4	41.2	165	177.8	25.4

Solenoid shown is hazardous location type -XX. For more options see page 6-7.
Manual override see page 17

For mounting hole dimensions see page 8

LATCHING, SINGLE SOLENOID, SPRING RETURN with PALM BUTTON

Side Ported	Function	Actuation	Pilot Type	Part Number	Weight	Flow Symbol
	3-Way 2-Position Normally Closed 3/2	Single Sole- noid, Latching Reset with Button	Inpilot	CAG-3321-316-356B-(*)	2.0 lbs 0.9 kg	
			Expilot	CAG-3301-316-356B-(*)		
	3-Way 2-Position- Normally Open 3/2	Single Sole- noid, Latching Reset with Button	Inpilot	CGA-3322-316-356B-(*)	2.0 lbs 0.9 kg	
			Expilot	CGA-3302-316-356B-(*)		
	4-Way 2-Position 5/2	Single Sole- noid, Latching Reset with Button	Inpilot	CAG-4322-316-356B-(*)	2.1 lbs 1.0 kg	
			Expilot	CAG-4302-316-356B-(*)		

* Add solenoid/coil voltages (page 7) & Suffix from Selector Chart (page 4)

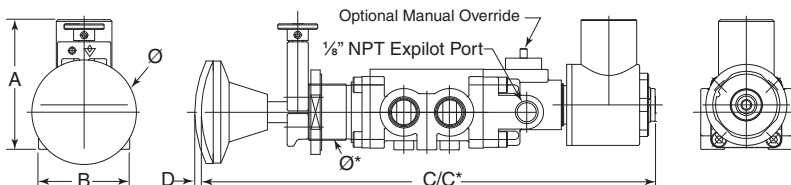

	A	B	C 3-Way	C* 4-Way	D Travel	Ø	Ø*
Inches	2.3	1.62	8.08	8.58	.20	1.81	1.0
mm	58.4	41.2	205.2	217.9	5.08	46	25.4

Solenoid shown is hazardous location type -XX. For more options see page 6-7.
Manual override see page 17

For mounting hole dimensions see page 8

THE C-316 SERIES

Body Ported Valves

PILOT OPERATED

Side Ported	Function	Actuation	Pilot Type	Part Number	Weight	Flow Symbol
	3-Way 2-Position Normally Closed 3/2	Single Pilot Spring Return	Remote Pilot	CSP-3301-316	1.0 lbs 0.5 kg	
	3-Way 2-Position Normally Open 3/2	Single Pilot Spring Return	Remote Pilot	CPS-3302-316	1.0 lbs 0.5 kg	
	3-Way 2-Position 3/2	Double Pilot Detent	Remote Pilot	CPP-3301-316	1.3 lbs 0.6 kg	
	4-Way 2-Position 5/2	Single Pilot Spring Return	Remote Pilot	CSP-4302-316	1.0 lbs 0.5 kg	
	4-Way 2-Position 5/2	Double Pilot Detent	Remote Pilot	CPP-4302-316	1.4 lbs 0.6 kg	

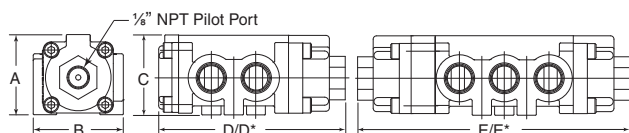

	A	B	C	D 3-Way	D* 4-Way	E 3-Way	E* 4-Way
Inches	2.8	1.62	1.42	3.36	3.86	4.43	4.94
mm	72.1	41.1	10.3	85	98	112.4	125.4

For mounting hole dimensions see page 8

PILOT, PALM BUTTON with SPRING RETURN

Side Ported	Function	Actuation	Pilot Type	Part Number	Weight	Flow Symbol
	3-Way 2-Position Normally Closed 3/2	Single Pilot Palm Button Spring Return	Remote Pilot	CAP-3301-316-136PE	1.3 lbs 0.6 kg	
	3-Way 2-Position Normally Open 3/2	Single Pilot Palm Button Spring Return	Remote Pilot	CPA-3302-316-136PE	1.3 lbs 0.6 kg	
	4-Way 2-Position 5/2	Single Pilot Palm Button Spring Return	Remote Pilot	CAP-4302-316-136PE	1.4 lbs 0.6 kg	

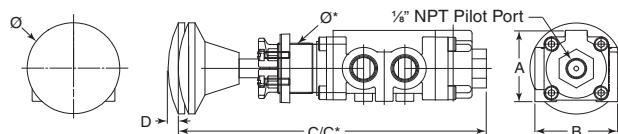



	A	B	C 3-Way	C* 4-Way	D Travel	Ø	Ø*
Inches	2.3	1.62	7.88	8.38	.20	1.81	1.0
mm	58.4	41.2	200.1	212.9	5.08	46	25.4

For mounting hole dimensions see page 8

THE C-316 SERIES

Body Ported Valves

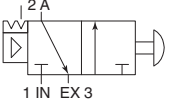
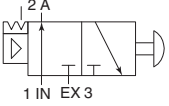
PILOT, PALM BUTTON with DETENT

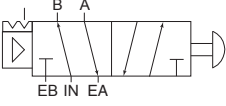
Side Ported	Function	Actuation	Pilot Type	Part Number	Weight	Flow Symbol
	3-Way 2-Position Normally Closed 3/2	Single Pilot Detent with Button	Remote Pilot	CAI-3301-316-150E	1.5 lbs 0.7 kg	
	3-Way 2-Position- Normally Open 3/2	Single Pilot Detent with Button	Remote Pilot	CIA-3302-316-150E	1.5 lbs 0.7 kg	
	4-Way 2-Position 5/2	Single Pilot Detent with Button	Remote Pilot	CAI-4302-316-150E	1.6 lbs 0.7 kg	

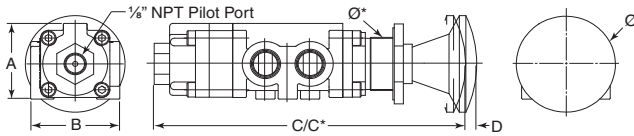

	A	B	C 3-Way	C* 4-Way	D Travel	Ø	Ø*
Inches	1.42	1.62	5.86	6.36	.20	1.81	1.0
mm	36.1	41.2	149	161.4	5.08	46	25.4

For mounting hole dimensions see page 8

LATCHING, PILOT, SPRING RETURN without PALM BUTTON

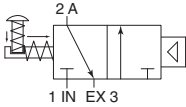
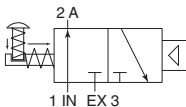
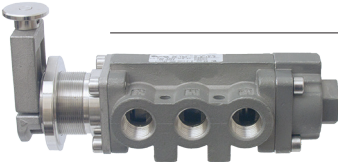
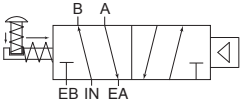
Side Ported	Function	Actuation	Pilot Type	Part Number	Weight	Flow Symbol
	3-Way 2-Position Normally Closed 3/2	Pilot, Latching, Spring Return	Remote Pilot	CAP-3301-316-356BN	1.3 lbs 0.6 kg	
	3-Way 2-Position- Normally Open 3/2	Pilot, Latching Spring Return	Remote Pilot	CPA-3302-316-356BN	1.3 lbs 0.6 kg	
	4-Way 2-Position 5/2	Pilot, Latching Spring Return	Remote Pilot	CAP-4302-316-356BN	1.4 lbs 0.6 kg	

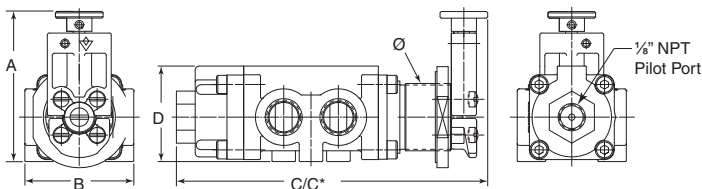

	A	B	C 3-Way	C* 4-Way	Ø
Inches	2.23	1.42	4.36	4.86	1.81
mm	56.6	36.1	117.5	123.4	46

For mounting hole dimensions see page 8

THE C-316 SERIES

Body Ported Valves

LATCHING, PILOT, SPRING RETURN with PALM BUTTON

Side Ported	Function	Actuation	Pilot Type	Part Number	Weight	Flow Symbol
	3-Way 2-Position Normally Closed 3/2	Pilot, Latching Reset with Palm Button	Remote Pilot	CAP-3301-316-356B	1.4 lbs 0.6 kg	
	3-Way 2-Position- Normally Open 3/2	Pilot, Latching Reset with Palm Button	Remote Pilot	CPA-3302-316-356B	1.4 lbs 0.6 kg	
	4-Way 2-Position 5/2	Pilot, Latching Reset with Palm Button	Remote Pilot	CAP-4302-316-356B	1.5 lbs 0.7 kg	

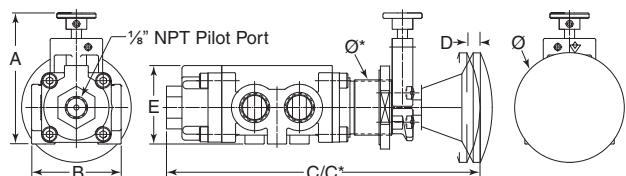

	A	B	C 3-Way	C* 4-Way	D Travel	E	Ø	Ø*
Inches	2.23	1.62	8.08	8.58	.20	2.3	1.81	1.0
mm	56.6	41.2	205.2	217.9	5.08	58.4	46	25.4

For mounting hole dimensions see page 8

MANUAL, PALM BUTTON, SPRING RETURN

Side Ported	Function	Actuation	Pilot Type	Part Number	Weight	Flow Symbol
	3-Way 2-Position Normally Closed 3/2	Palm Button Spring Return	NA	CSI-3301-316	1.1 lbs 0.5 kg	
	3-Way 2-Position- Normally Open 3/2	Palm Button Spring Return	NA	CIS-3302-316	1.1 lbs 0.5 kg	
	4-Way 2-Position 5/2	Palm Button Spring Return	NA	CSI-4302-316	1.3 lbs 0.6 kg	

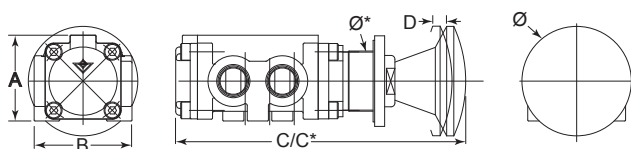

	A	B	C 3-Way	C* 4-Way	D Travel	Ø	Ø*
Inches	2.3	1.62	8.08	8.58	.20	1.81	1.0
mm	58.4	41.2	205.2	217.9	5.08	46	25.4

For mounting hole dimensions see page 8

THE C-316 SERIES

Body Ported Valves

MANUAL, PALM BUTTON, DETENTED

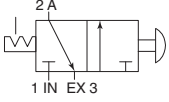
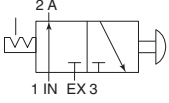
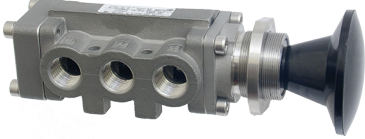
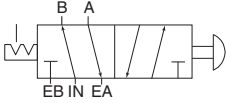
Side Ported	Function	Actuation	Pilot Type	Part Number	Weight	Flow Symbol
	3-Way 2-Position Normally Closed 3/2	Palm Button Detent	NA	CZI-3301-316	1.3 lbs 0.6 kg	
	3-Way 2-Position- Normally Open 3/2	Palm Button Detent	NA	CIZ-3302-316	1.3 lbs 0.6 kg	
	4-Way 2-Position 5/2	Palm Button Detent	NA	CZI-4302-316	1.4 lbs 0.6 kg	

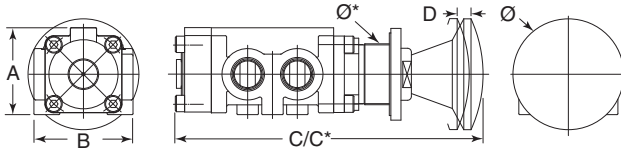

	A	B	C 3-Way	C* 4-Way	D Travel	Ø	Ø*
Inches	1.42	1.62	4.8	5.3	.20	1.81	1.0
mm	36.1	41.2	122	135	5.1	46	25.4

For mounting hole dimensions see page 8

MANUAL, ROTARY, SPRING RETURN & DETENTED

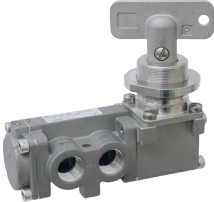
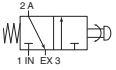
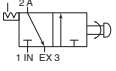
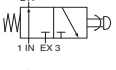
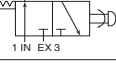
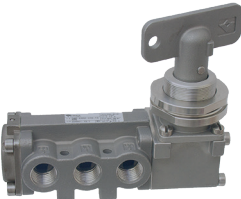
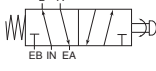
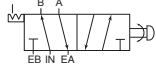
Side Ported	Function	Actuation	Pilot Type	Part Number	Weight	Flow Symbol
	3-Way 2-Position Normally Closed 3/2	Spring Return Detent	NA	CSA-3301-316-357E CZA-3301-316-357E(*)	1.6 lbs 0.7 kg 1.8 lbs 0.8 kg	 
	3-Way 2-Position Normally Open 3/2	Spring Return Detent	NA	CAS-3302-316-357E CAZ-3302-316-357E(*)	1.6 lbs 0.7 kg 1.8 lbs 0.8 kg	 
	4-Way 2-Position 5/2	Spring Return Detent	NA	CSA-4302-316-357E CAZ-3302-316-357E(*)	1.8 lbs 0.8 kg 2.0 lbs 0.9 kg	 

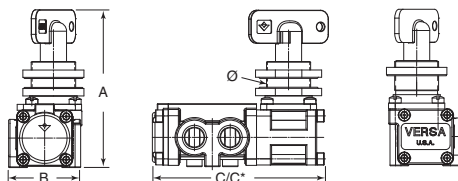

	A	B	C 3-Way	C* 4-Way	Ø
Inches	3.5	1.62	3.73	4.23	1.0
mm	90	41.2	95	107.4	25.4

For mounting hole dimensions see page 8

THE C-316 SERIES

Body Ported Valves

MANUAL, KEY, SPRING RETURN & DETENT

Side Ported	Function	Actuation	Pilot Type	Part Number	Weight	Flow Symbol
	3-Way 2-Position Normally Closed 3/2	Spring Return	NA	CSA-3301-316-314E(*)	1.8 lbs 0.8 kg	
		Detent		CZA-3301-316-314E(*)	1.9 lbs 0.9 kg	
	3-Way 2-Position- Normally Open 3/2	Spring Return	NA	CAS-3302-316-314E(*)	1.8 lbs 0.8 kg	
		Detent		CAZ-3301-316-314E(*)	1.9 lbs 0.9 kg	
	4-Way 2-Position 5/2	Spring Return	NA	CSA-4302-316-314E(*)	2 lbs 0.9 kg	
		Detent		CAZ-4302-316-314E(*)		

*Key Number - Key number assigned by Versa

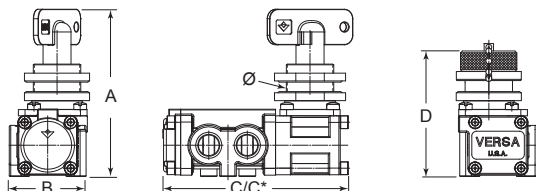

	A	B	C 3-Way	C* 4-Way	D	Ø
Inches	3.5	1.62	3.73	4.23	2.8	1.0
mm	90	41.2	95	107.4	71.3	24.5

For mounting hole dimensions see page 8

MANUAL, KEY, PILOT RETURN

Side Ported	Function	Actuation	Pilot Type	Part Number	Weight	Flow Symbol
	3-Way 2-Position Normally Closed 3/2	Key Pilot Return	Remote Pilot	CPA-3301-316-314E(*)	2 lbs 0.9 kg	
		Key Pilot Return	Remote Pilot	CAP-3302-316-314E(*)	2 lbs 0.9 kg	
	4-Way 2-Position 5/2	Key Pilot Return	Remote Pilot	CPA-4302-316-314E(*)	2 lbs 0.9 kg	

*Key Number - Key number assigned by Versa

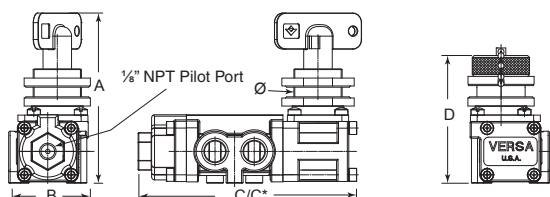



	A	B	C 3-Way	C* 4-Way	D	Ø
Inches	3.53	1.62	8.08	8.58	2.8	1.0
mm	90	41.2	205.2	217.9	71.3	24.5

For mounting hole dimensions see page 8

THE C-316 SERIES

Body Ported Valves

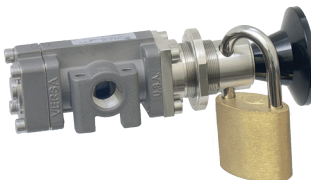
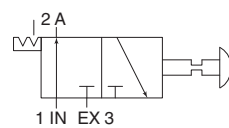
MANUAL, LOCK - OUT

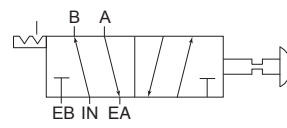
Side Ported	Function	Actuation	Pilot Type	Part Number	Weight	Flow Symbol
	3-Way 2-Position Normally Closed 3/2	Palm Button Detent	NA	CIZ-3301-316-LOVBE	1.3 lbs 0.6	
	4-Way 2-Position 5/2	Palm Button Detent	NA	CIZ-4302-316-LOVEE	1.4 lbs 0.6	

Note: locks not included

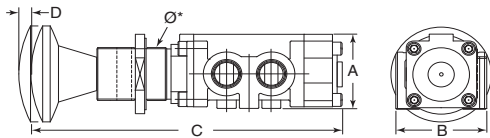

	A	B	C (3-Way)	C* (4-Way)	D (Travel)	Ø	Ø*
Inches	2.3	1.62	8.08	8.58	.20	1.81	1.0
mm	58.4	41.2	205.2	217.9	5.08	46	25.4

For mounting hole dimensions see page 8

MANUAL, By Pass Valve

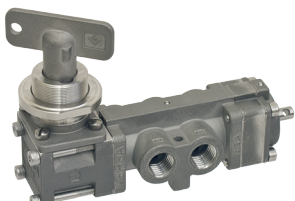
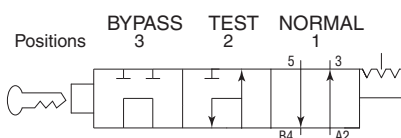
Side Ported	Function	Actuation	Pilot Type	Part Number	Weight	Flow Symbol
	1/4" NPT* 4Way 3-Position	Key Operated	NA	CAU-430X-316-314E***-2039 (***) = key code assigned at factory Add -9E Suffix Detail for Extended Plunger	2 lbs 0.9 kg	

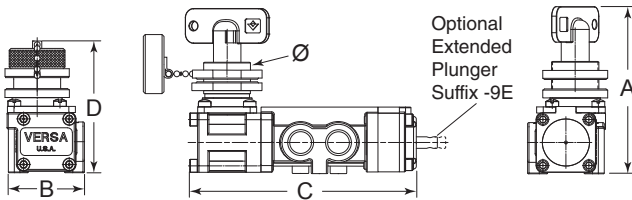

	A	B	C	D*	E	Ø
Inches	3.53	1.62	5.14	4.7	2.8	1.0
mm	90	41.2	130	217.9	71.3	24.5

For mounting hole dimensions see page 8

The, basic valve is a 3 position manual valve. Operation is as follows:

Position 1. This position is the normal position or the regular operation mode.

Position 2. This position places the control circuit in the test mode. In this position the bypass valve allows pressure to the circuit for testing while maintaining pressure on the actuator. With pressure to solenoid inlet and solenoid circuit outlet blocked/isolated this position allows complete testing of solenoid circuit while not shutting down the system.

Position 3. This position places the control system in a replace mode. Should it be determined that a component in the control circuit needs to be repaired and or replaced this position allows total isolation from pressure while still holding system pressure to actuator.

*1/2" NPT available; part number: VAU-450X-316-314E507-2039. See V-316 Series.

THE C-316 SERIES NAMUR

NAMUR, SOLENOID OPERATED

Note:
3-Way & 4-Way
NAMUR valves
look the same
externally.

NAMUR	Function	Actuation	Pilot Type	Part Number	Weight	Flow Symbol
	3-Way 2-Position Normally Closed 3/2	Single Solenoid Spring Return	Inpilot	CGS-3331-316-NE†-(*)	1.7 lbs 0.8 kg	
	3-Way 2-Position- Normally Open 3/2	Single Solenoid Spring Return	Inpilot	CSG-3332-316-NE†-(*)	1.7 lbs 0.8 kg	
	3-Way 2-Position 3/2	Double Solenoid Detent	Inpilot	CGG-3331-316-NE†-(*)	2.3 lbs 1.0 kg	
	4-Way 2-Position 5/2	Single Solenoid Spring Return	Inpilot	CGS-4332-316-NE†-(*)	1.7 lbs 0.8 kg	
	4-Way 2-Position 5/2	Double Solenoid Detent	Inpilot	CGG-4332-316-NE†-(*)	2.3 lbs 1.0 kg	

† Add mounting screw type from Selector Chart "Suffix" column (page 4) * Add solenoid/coil voltages (page 7) & Suffix from Selector Chart (page 4).

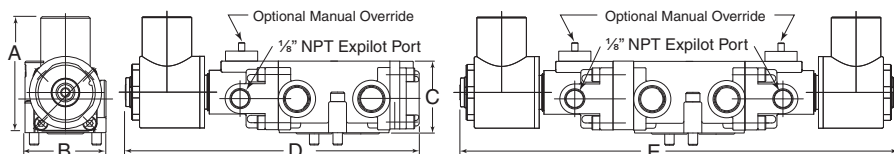

	A	B	C	D	E
Inches	2.3	1.62	1.4	5.7	8.8
mm	58.4	41.2	36.6	144	223

Solenoid shown is hazardous location type -XX. For more options see page 6-7. Manual override see page 17

NAMUR LATCHING, SOLENOID, SPRING RETURN without PALM BUTTON

NAMUR	Function	Actuation**	Pilot Type	Part Number	Weight	Flow Symbol
	3-Way 2-Position Normally Closed 3/2	Pilot, Latching Reset without Button	Inpilot	CGA-3331-316-NE†-356BN-(*)	1.5 lbs 0.7 kg	
	4-Way 2-Position 5/2	Single Solenoid, Latching Reset without Button	Inpilot	CAG-4332-316-NE†-356BN-(*)	1.5 lbs 0.7 kg	

† Add mounting screw type from Selector Chart "Suffix" column (page 4) . * Add solenoid/coil voltages (page 7) & Suffix from Selector Chart (page 8).

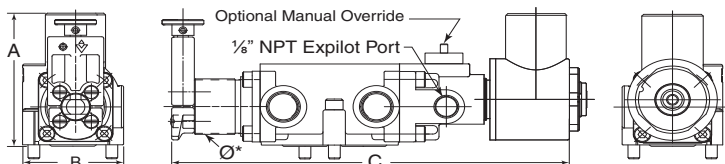

**Consult
factory for other
configurations

	A	B	C	Ø*
Inches	2.23	1.62	5.7	1
mm	56.6	41.2	144	25.4

Solenoid shown is hazardous location type -XX. For more options see page 6-7. Manual override see page 17

THE C-316 SERIES

Body Ported Valves

MANUAL, CAM

Side Ported	Function	Actuation	Pilot Type	Part Number	Weight	Flow Symbol
	3-Way 2-Position Normally Closed 3/2	Cam Spring Return	NA	CSC-3301-316	1.0 lbs 0.5 kg	
	3-Way 2-Position Normally Open 3/2	Cam Spring Return	NA	CCS-3302-316	1.0 lbs 0.5 kg	
	4-Way 2-Position 5/2	Cam Spring Return	NA	CSC-4302-316	1.0 lbs 0.5 kg	

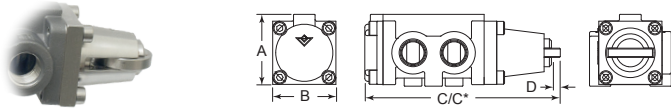

Standard Cam

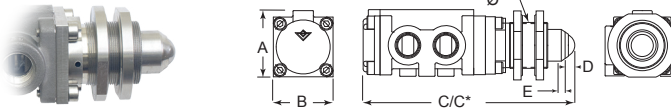

Over Travel Cam Suffix -18E

	A	B	C (3-Way)	C* (4-Way)	D (Travel)	E (Over Travel)	Ø
Inches	1.42	1.62	3.87	4.37	.20	0.19	1.0
mm	58.4	41.2	110.9	217.9	5.08	4.8	25.4

For mounting hole dimensions see page 8

Options

Override

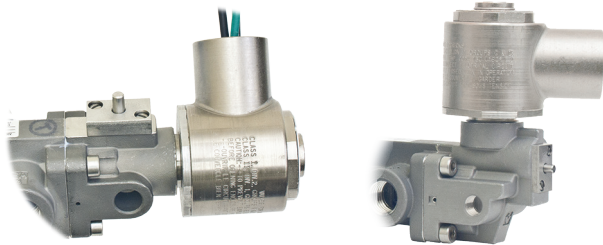

-ME
Override

On Standard Solenoid Cap

-ME -U
Override

On Up Right Solenoid Cap

Solenoid Vent Options



Hydraulic Adapter

-H2 1/8"
-H 1/4"

Excluders

-L14
Dust Proof

-D14
Water Tight

Stainless Steel Tag

ORDERING INFORMATION

Order any B-316, C-316, T, V or V-316 valve. As a separate line item (listed directly under valve part number to be tagged) list the tag part number P- 2002-16-NV28A. In remarks field specify the tag marking instructions. If sequential numbering is required provide the start and end numbers required in the sequence for the appropriate number of valves.



Engraving Options

Versa's engraved tags are available in two configurations.

Configuration one: is a simple text field consisting of two lines of text, 20 characters maximum per line. The text can be specified as alpha, numeric or both.

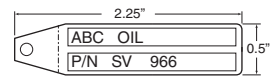

Configuration two: is a text field with sequential numbering added. This option includes two lines of text. Line one is text. Line two allows for sequentially numbering the tag, 20 characters maximum per line.

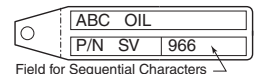

**Versa
has been
supplying the
oil and gas
industry with
pneumatic
and hydraulic
components
for over 70
years. We
have built a
reputation
for quality
that is
unsurpassed
in the market
for high
performance
solenoids,
pneumatic
relays, resets
and pilot
valves**

**WARNINGS REGARDING THE DESIGN APPLICATION,
INSTALLATION AND SERVICE OF VERSA PRODUCTS**

The warnings below must be read and reviewed before designing a system utilizing, installing, servicing, or removing a Versa product. Improper use, installation or servicing of a Versa product could create a hazard to personnel and property.

DESIGN APPLICATION WARNINGS

Versa products are intended for use where compressed air or industrial hydraulic fluids are present. For use with media other than specified or for non-industrial applications or other applications not within published specifications, consult Versa.

Versa products are not inherently dangerous. They are only a component of a larger system. The system in which a Versa product is used must include adequate safeguards to prevent injury or damage in the event of system or product failure, whether this failure be of switches, regulators, cylinders, valves or any other system component. System designers must provide adequate warnings for each system in which a Versa product is utilized. These warnings, including those set forth herein, should be provided by the designer to those who will come in contact with the system.

Where questions exist regarding the applicability of a Versa product to a given use, inquiries should be addressed directly to the manufacturer. Confirmation should be obtained directly from the manufacturer regarding any questioned application prior to proceeding.

INSTALLATION, OPERATION AND SERVICE WARNINGS

Do not install or service any Versa product on a system or machine without first depressurizing the system and turning off any air, fluid, or electricity to the system or machine. All applicable electrical, mechanical, and safety codes, as well as applicable governmental regulations and laws must be complied with when installing or servicing a Versa product.

Versa products should only be installed or serviced by qualified, knowledgeable personnel who understand how these specific products are to be installed and operated. The individual must be familiar with the particular specifications, including specifications for temperature, pressure, lubrication, environment and filtration for the Versa product which is being installed or serviced. Specifications may be obtained upon request directly from Versa. If damages should occur to a Versa product, do not Operate the system containing the Versa product. Consult Versa for technical information.

**LIMITED WARRANTY DISCLAIMER
AND LIMITATION OF REMEDIES**
Versa's Series products are warranted to be free from defective material and workmanship for a period of ten years from the date of manufacture, provided said products are used in accordance with Versa specifications. Versa's liability pursuant to that warranty is limited to the replacement of the Versa product proved to be defective provided the allegedly defective product is returned to Versa or its authorized distributor. Versa provides no other warranties, expressed or implied, except as stated above. There are no implied warranties of merchantability or fitness for a particular purpose. Versa's liability for breach of warranty as herein stated is the only and exclusive remedy and in no event shall Versa be responsible or liable for incidental or consequential damages.

Versa Products Company, Inc.
22 Spring Valley Road
Paramus, New Jersey 07652
USA
Phone: 201-843-2400
Fax: 201-843-2931

Versa BV
Prins Willem Alexanderlaan
1427
7321 GB Apeldoorn
The Netherlands
Phone: 01131-55-368-1900
Fax: 01131-55-368-1909



www.versa-valves.com
email: sales@versa-valves.com